

notes

THIS DRAWING SHOULD BE READ IN CONJUNCTION WITH ELECTRICITY NORTH WEST ES 352 AND ALL ASSOCIATED WORKS MUST COMPLY WITH THIS INFORMATION AND DETAIL IN FULL.

AFTER ASSEMBLY OF VENTILATION UNIT - MINIMUM INGRESS PROTECTION RATING 4:4. ALL VENTILATION AREAS MUST COMPLY WITH BS EN 60529, WITH A MINIMUM VENTILATION AREA OF 0.75m². DESIGNS BY APPROVAL OF ELECTRICITY NORTH WEST.

INSTALLATION:

INSERT VENT FROM OUTSIDE CENTRALISE USING SHIMS.
 SECURE REAR FIXING FLANGE.
 INJECT PERIPHERAL CAVITY WITH FOAM SILICONE SEALANT SURROUND OUTSIDE

IF REQUIRED, BRACKETS ARE AVAILABLE FOR RETROFITTING.

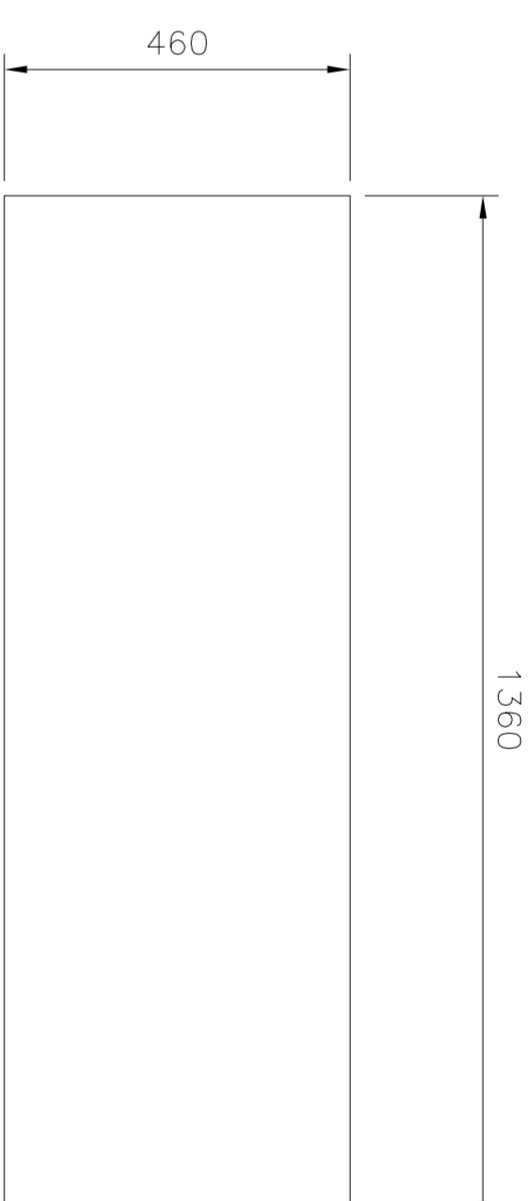

FRONT ELEVATION SHOWING STRUCTURAL OPENING

ALL DIMENSIONS SHOWN ON THIS DRAWING ARE NOMINAL AND WILL CHANGE TO SUIT REQUIRED OPENING IN WALL

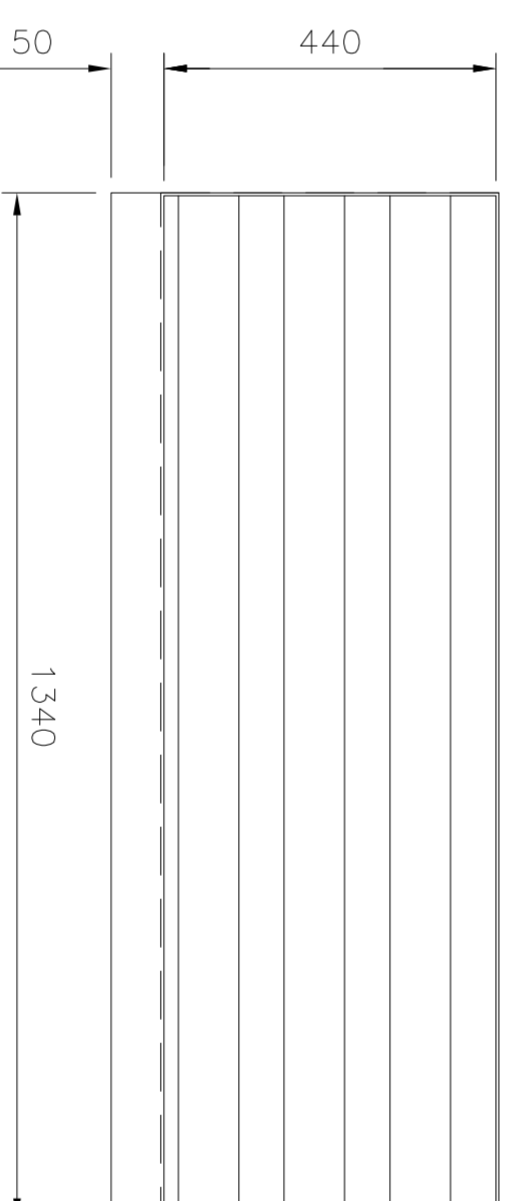

FRONT ELEVATION SHOWING THE LOUVRE.

IN SITU CONCRETE LINTEL ACROSS THE INNER LEAF OF BRICK OR BLOCKWORK, WITH 150 MIN. END BEARING ON EITHER SIDE OF THE OPENING. PERFORMED STEEL LINTEL SUFFICIENT TO SPAN THE OPENING LEFT FOR THE PROVISION OF A STANDARD WALL.

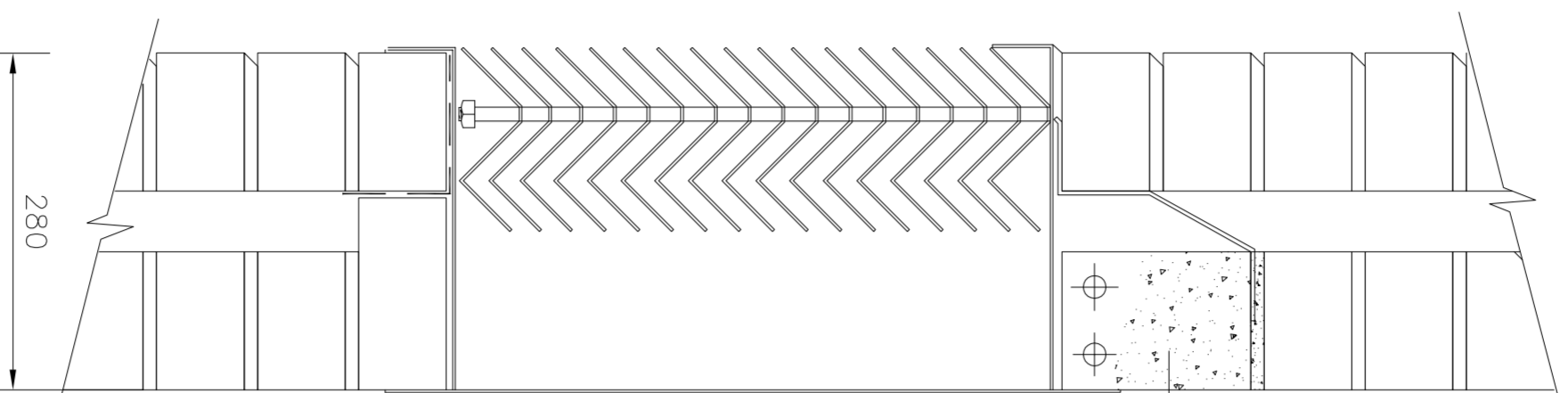

SECTION THROUGH WALL



DRAWN		SCALE		SITE NAME	
ASR		1:5		-	
APPROVED		DATE		P.F.R. NO.	
WD		NOVEMBER 18		900350-031	
OLD DWG NO.		SHEET SIZE		DWG STATUS	
-		A2		-	
FREDERICK ROAD, SALFORD M6 6QH TEL 0161 6041370				CIVIL DISTRIBUTION SUBSTATION CONSTRUCTION DETAILS FOR STANDARD WALL LOUVRE	
REV		APPROVAL		REV	
0				0	