

**GENERAL NOTES**

- DO NOT SCALE THIS DRAWING. TAKE FIGURED DIMENSIONS ONLY
- ALL COMPONENTS MILD STEEL GRADE 43
- ALL COMPONENTS HOT DIPPED GALVANISED AFTER FABRICATION TO BS 729
- ALL BOLTS TO BE GRADE 8.8 GALVANISED AND HAVE PERMANENT NUTS OR LOCKNUTS
- ALL WELDS 6MM FILET FULL & CONTINUOUS, DRESSED SMOOTH AND FREE FROM SHARP EDGES
- ALL GATES TO OPEN OUT FROM SUBSTATION
- ALL LEAVES ACTIVE

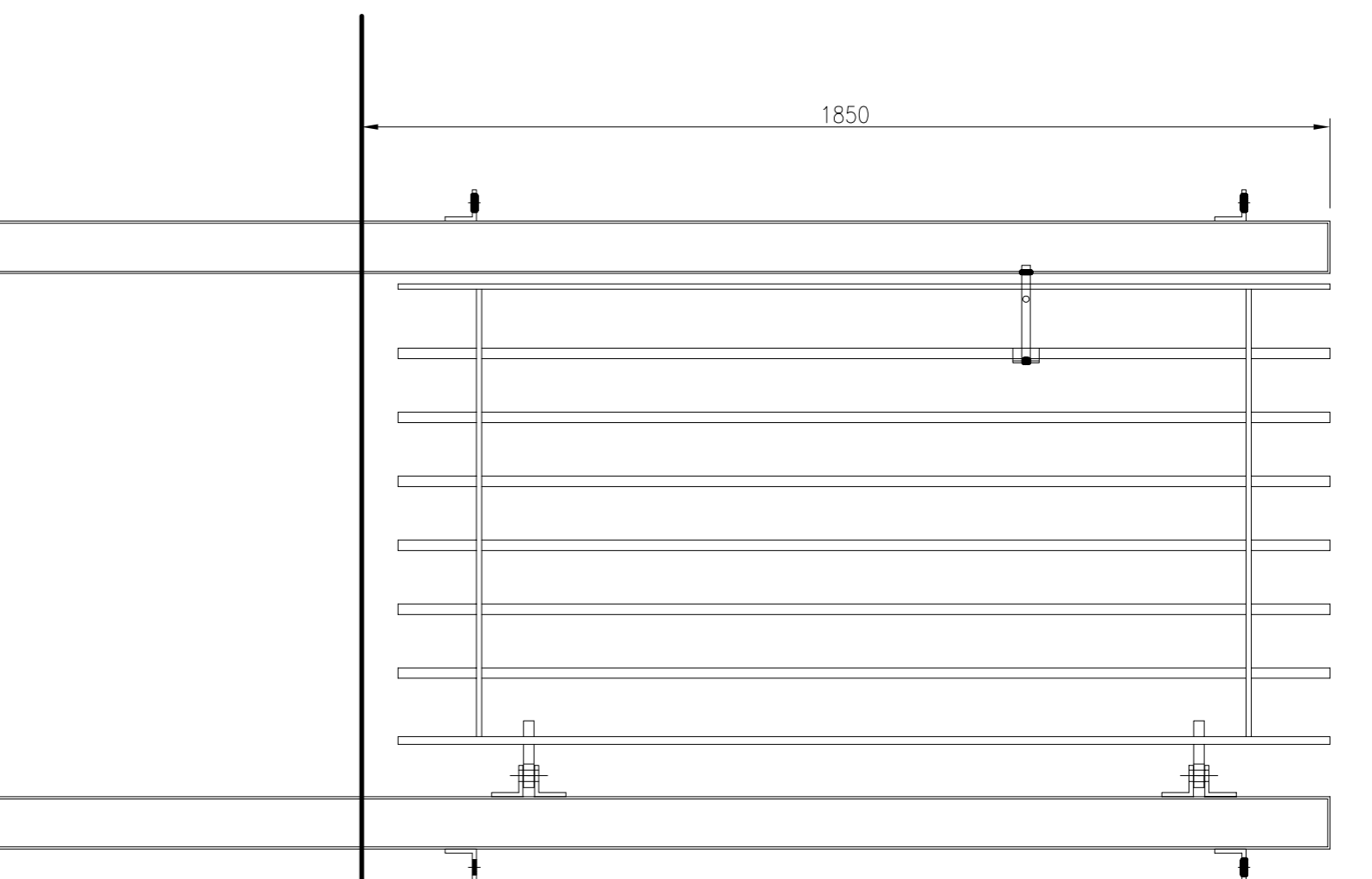

TYPICAL ELEVATION ON GATE  
(SCALE 1:12.5)

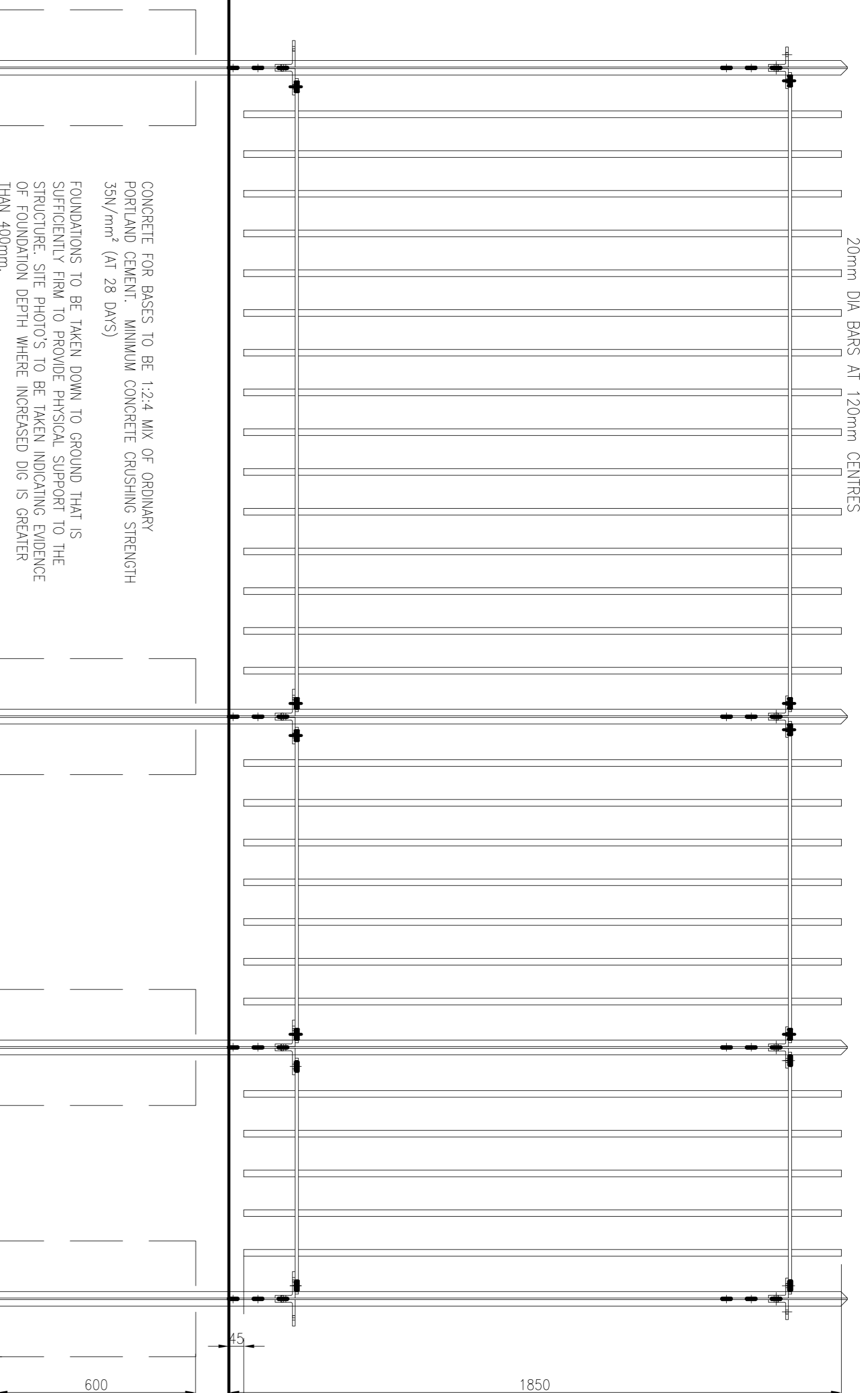

TYPICAL ELEVATION ON 1850mm HIGH MODULAR FENCE  
(SCALE 1:12.5)

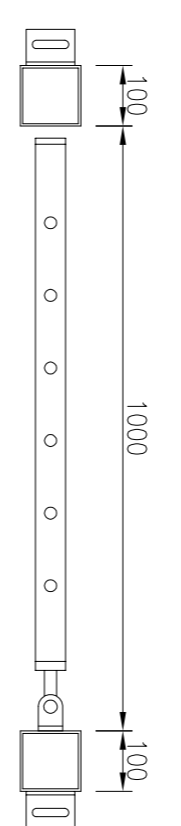

TYPICAL PLAN ON GATE  
(SCALE 1:12.5)

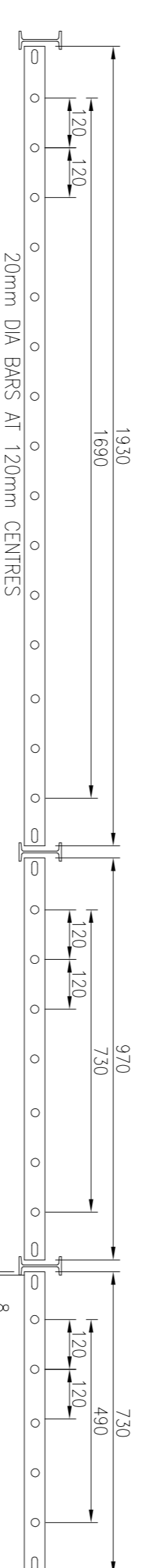

TYPICAL MODULAR FENCE PLAN  
(SCALE 1:12.5)

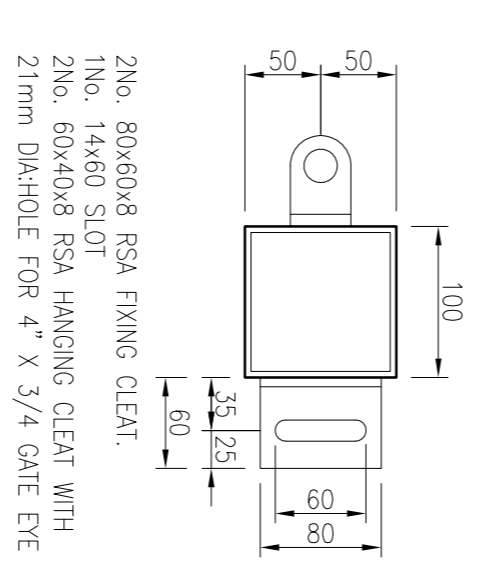

TYPICAL GATE POST PLAN  
(SCALE 1:5)

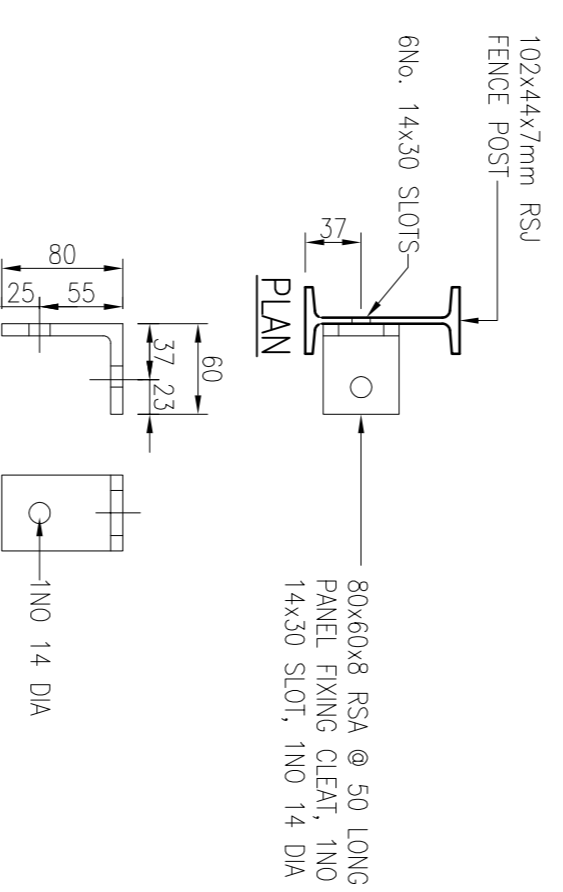

TYPICAL FENCE POST DETAIL  
(AND FIXING CLEAR)  
(SCALE 1:5)

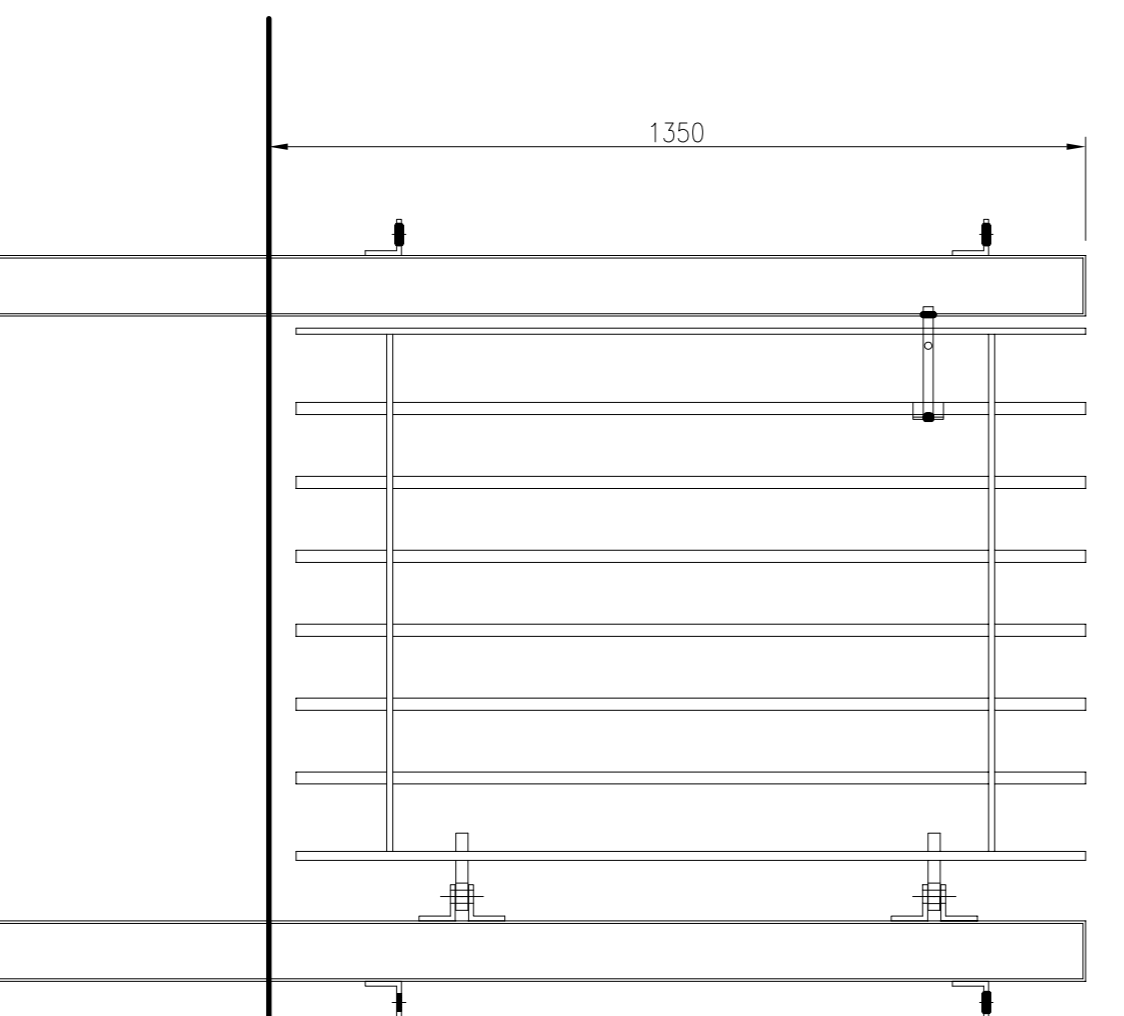

TYPICAL ELEVATION ON GATE  
(SCALE 1:12.5)

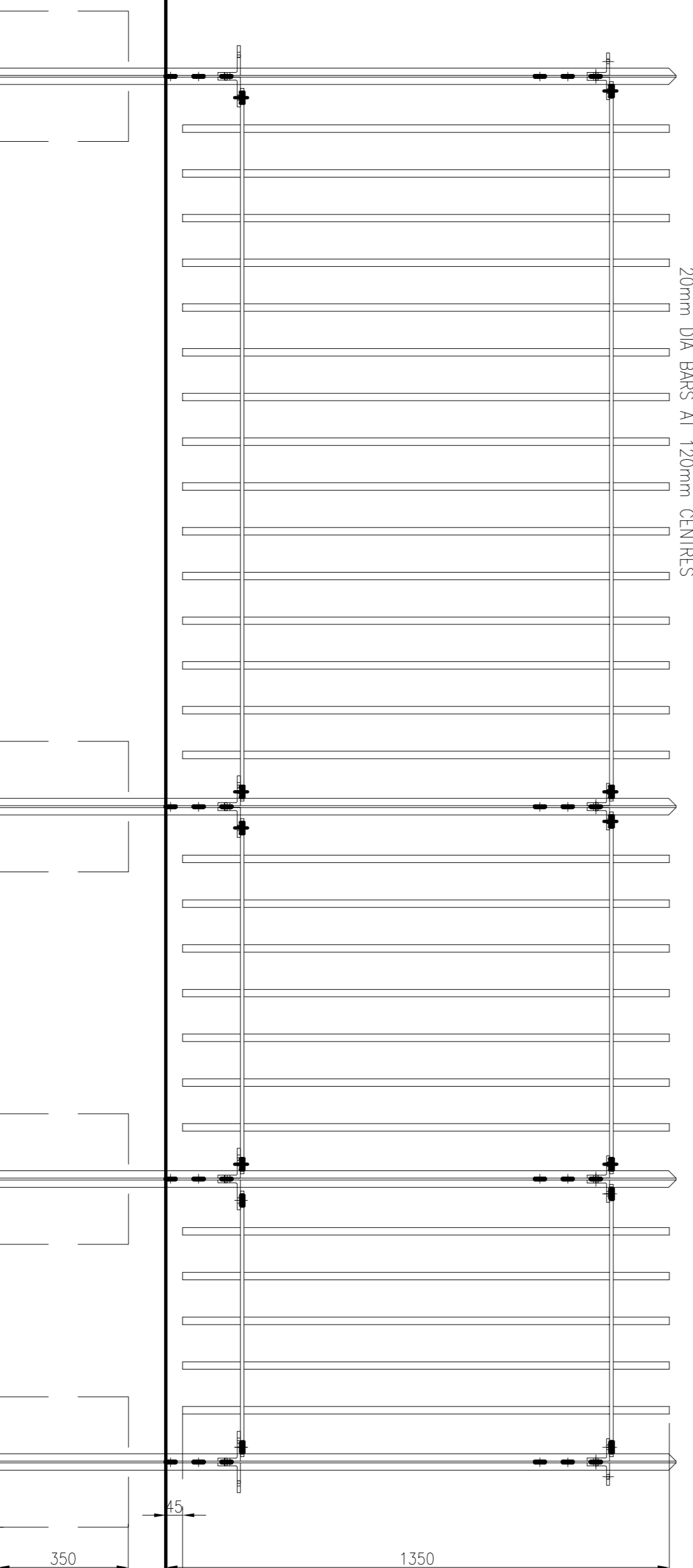

TYPICAL ELEVATION ON 1350mm HIGH MODULAR FENCE  
(SCALE 1:12.5)

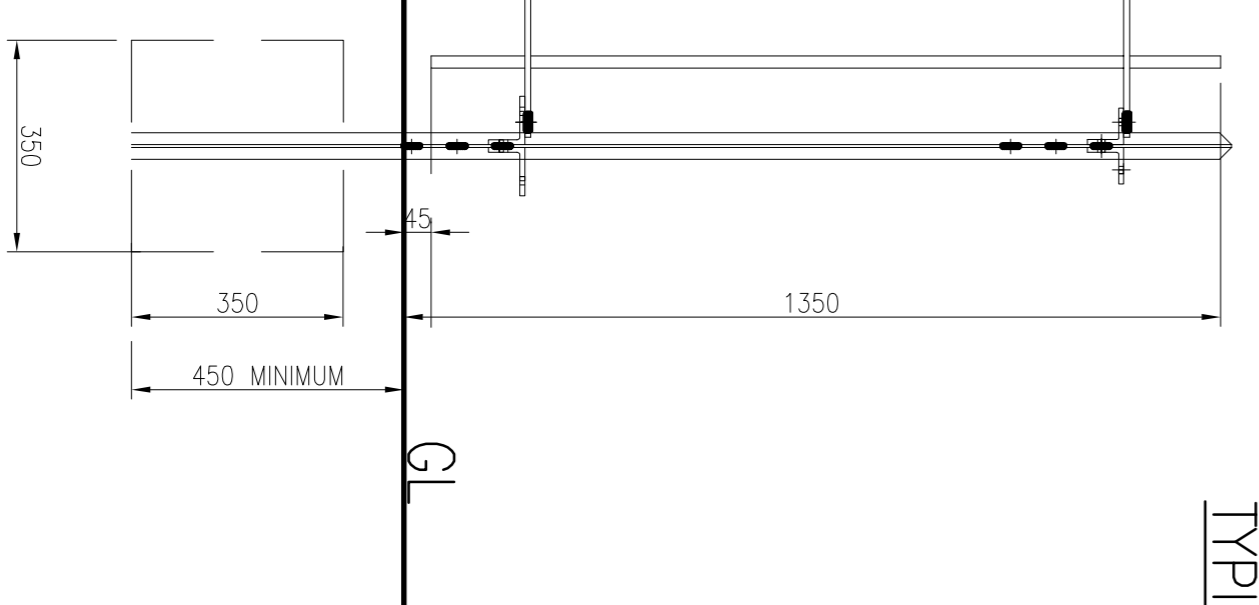

TYPICAL GATE POST PLAN  
(SCALE 1:5)

NOT TO SCALE

<b>calernicity</b> northwest		FREDERICK ROAD, SALFORD M6 6QH TEL 0161 6041370		CIVIL DISTRIBUTION SUBSTATION	
DRAWN	JEWB	SCALE	AS SHOWN @A1	SITE NAME	MODULAR FENCE
APPROVED		DATE	JULY 16	P.F.R. NO.	1850mm & 1350mm HIGH
OLD DWG NO.	-	SHEET SIZE	A1	DWG NO.	900350-024
				DWG STATUS	APPROVAL
				REV	0