

**PLAN VIEW**

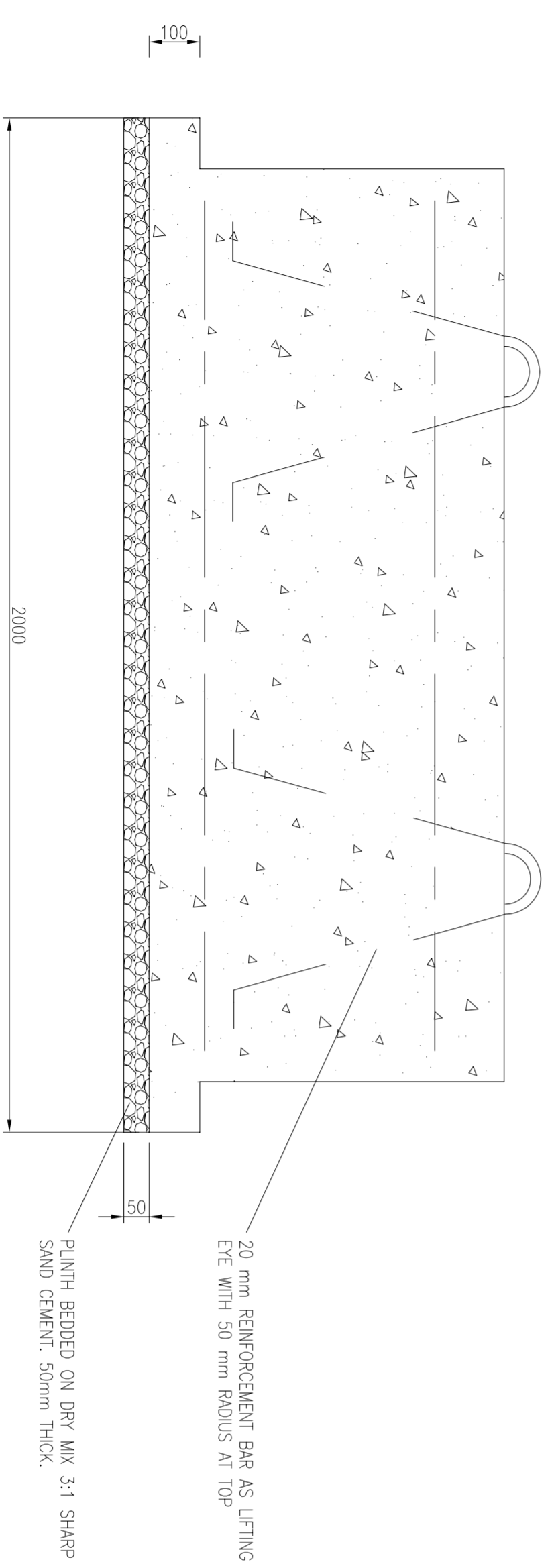

20 mm REINFORCEMENT BAR AS LIFTING EYE WITH 50 mm RADIUS AT TOP

PLINTH BEDED ON DRY MIX 3:1 SHARP SAND CEMENT. 50mm THICK.

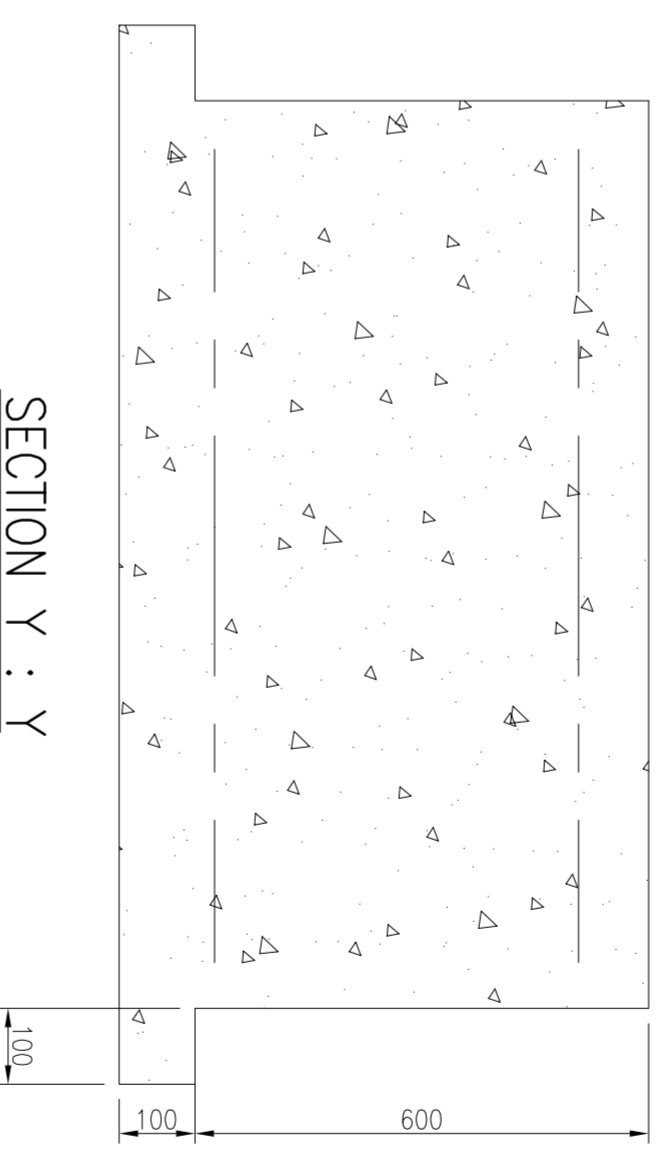

**SECTION Y : Y**

SWITCHGEAR PLINTH TO 700 THICK CONCRETE WITH A252 REINFORCEMENT TOP & BOTTOM WITH 50 MM COVER TO SIDES AND TOP ARRISES TO BE REMOVED FROM TOP EDGES OF PLINTH

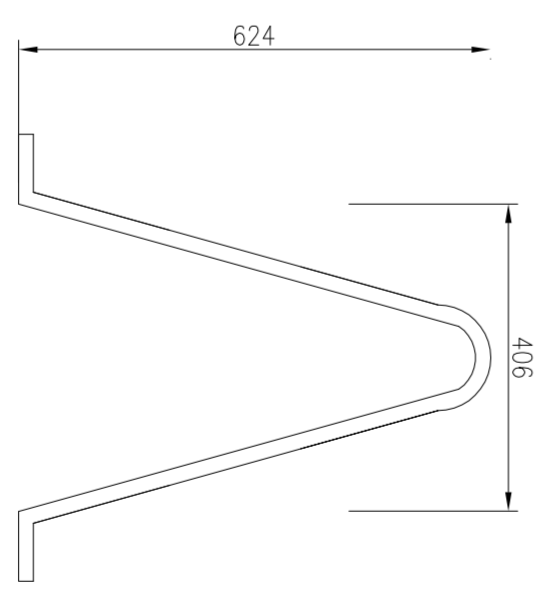

**REINFORCEMENT BAR DETAIL**

**NOT TO SCALE**

**SITE NOTES**

1. CONTRACTOR TO OBTAIN UNDERGROUND CABLE & SERVICE RECORDS PRIOR TO COMMENCEMENT OF ANY WORKS.
2. THE CONTRACTOR MUST ASSUME THAT ANY EXISTING CABLES LOCATED WITHIN THE WORKS ARE LIVE AND LAISE WITH THE ELECTRICITY NORTHWEST ENGINEER FOR ADVICE.
3. SITE SPECIFIC RISK ASSESSMENT TO BE UNDERTAKEN PRIOR TO COMMENCEMENT OF ANY WORKS.
4. FOUNDATION DESIGN HAS BEEN BASED ON A SUITABLE BEARING PRESSURE FOR MOST GROUND CONDITIONS INCLUDING CLAYS. FORMATION LEVEL FOR FOUNDATIONS TO BE TAKEN DOWN TO GROUND THAT IS SUFFICIENTLY FIRM TO PROVIDE PHYSICAL SUPPORT TO THE STRUCTURE.
5. FOUNDATION FORMATION LEVELS TO BE INSPECTED AND APPROVED PRIOR TO FOUNDATION CONSTRUCTION.

**GENERAL NOTES**

1. DO NOT SCALE.
2. ALL DIMENSIONS ARE IN MILLIMETRES UNLESS NOTED OTHERWISE.
3. THIS DRAWING IS TO BE READ IN CONJUNCTION WITH ELECTRICITY NORTHWEST CODE OF PRACTICE ES352
4. ALL WORK TO CARRIED OUT IN ACCORDANCE WITH CURRENT BUILDING REGULATIONS AND RELEVANT BRITISH STANDARDS AND CODES OF PRACTICE.
5. CONCRETE TO BE STRENGTH CLASS C32/40 TO BS8500

		FREDERICK ROAD, SALFORD		CIVIL DISTRIBUTION SUBSTATION	
		M6 6QH TEL 0161 6041370		PLINTH FOR TRANSPORTABLE UNIT SUBSTATION	
DRAWN	JEWB	SCALE	NTS	SITE NAME	
APPROVED		DATE	JULY 16	P.F.R. NO.	
OLD DWG NO.		SHEET SIZE	A2	DWG NO.	900350-021
				DWG STATUS	APPROVAL
				REV	0

**SECTION X : X**